

# Frank Gehry



Weatherhead School, Frank Gehry  
Designed in 1999



Guggenheim-Museum, Frank Gehry  
Designed in 1997



Guggenheim-Museum, Frank Gehry  
Built in 2006

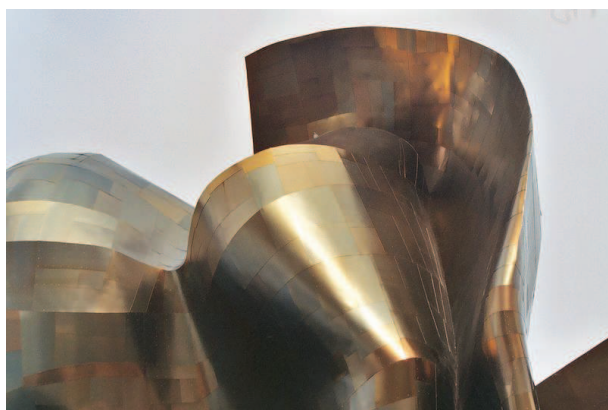

Experience Music Project, Frank Gehry  
Designed in 2000



MARTa Herford, Frank Gehry  
Built in 2001 - 2005



Der Neue Zollhof, Düsseldorf  
Built in 1999



Gehry-Tower, Hannover  
Built in 2000 - 2001

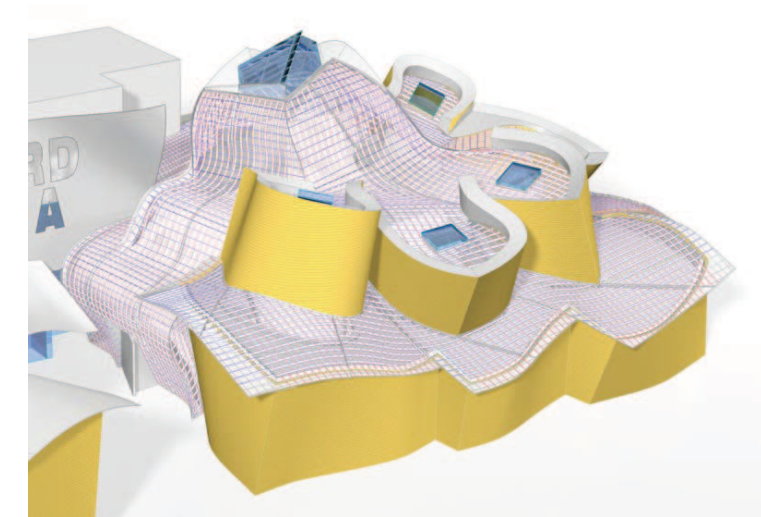

MARTa Herford, Frank Gehry  
Rhinoceros offers the possibility to work with developable surfaces by "lofting" two curves.

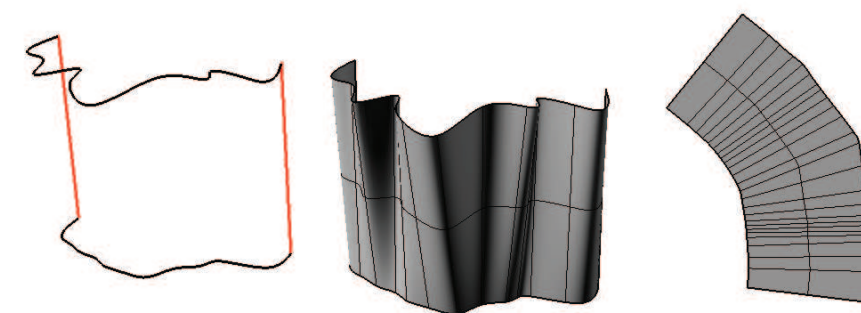

The shape of this building can be obtained by lofting two different curves together. Because of the fact that it's a curved surface it can be unrolled.

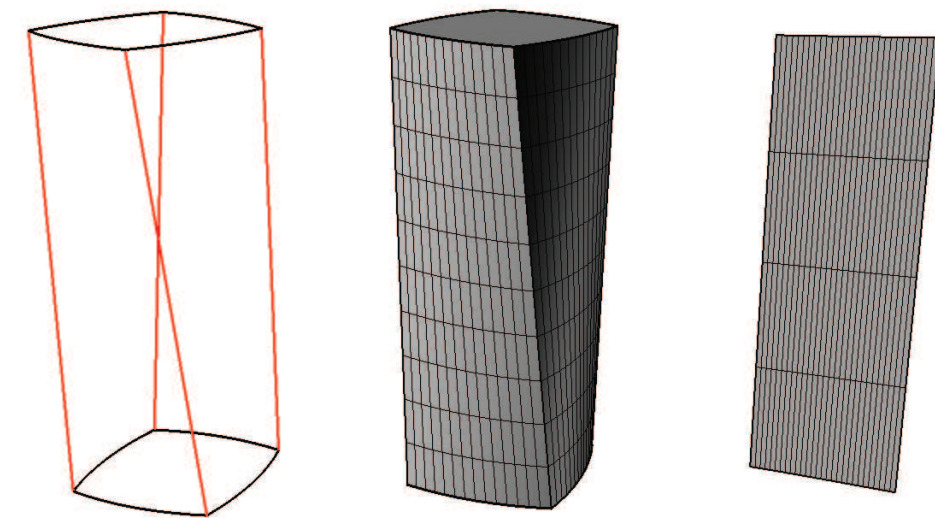

This time the building shape can be obtained by slightly twisting the upside of the building compared to the bottom one.